



SSWR

Society for Social Work and Research

January 14-18, 2026



Leading for Transformative Change:

*Aligning Social Work Science
with Policy and Practice*

Program Schedule

Marriott Marquis Washington DC



SHAPING THE FUTURE OF SOCIAL WORK

**INNOVATION AND EQUITY AT THE CORE OF
INTERDISCIPLINARY SOCIAL WORK RESEARCH**



School of Social Work
UNIVERSITY OF ILLINOIS URBANA-CHAMPAIGN



Table of Contents

President's Welcome	4
Celebrating 30th Conference Anniversary.....	7
2026 Exhibitors.....	9
Program Overview.....	11
General Information	19-21
• ADA Assistance	
• Admission to Conference Activities	
• Conference Mobile APP	
• Continuing Education Units (CEUs)	
• Cover photo credits for the 2026 SSWR printed cover	
• Gender Inclusive Restrooms	
• Health and Safety at SSWR 2026	
• Anti-harassment Policy	
• Land Acknowledgment	
• Name Badges and Pronouns	
• Parents' Nursing Room	
• Photo and Video Release Statement & Agreement	
• "Quiet" Room	
• Wi-Fi Access	
Preconference Sessions: Research Methods Workshops and Special Sessions.....	24
on Research Priorities and Capacity Building	
2026 Sponsors.....	38
In Memoriam	41
2026 Awards.....	42
2026 Fellows.....	48
2025-2026 Board of Directors.....	50
2026 Conference Committee.....	52
2026 Conference Abstract Cluster Co-Chairs.....	52
Journal of the Society for Social Work and Research (JSSWR)	55
Editor-in-Chief, Associate Editors, Managing Editor, and Editorial Assistant	
Marriott Marquis Washington, DC, Meeting Room Floor Plans.....	57



Dear Colleagues,

It is with great pleasure that I welcome you to Washington, DC for the 2026 Annual Conference of the Society for Social Work and Research (SSWR). Each year, our gathering offers a unique opportunity to engage with the latest advancements in social work research, celebrate the achievements of our doctoral students and early career scholars, honor career milestones, and reflect on the many ways our collective work addresses some of the most pressing social and economic challenges.

This year's conference theme—Leading for Transformative Change: Aligning Social Work Science with Policy and Practice—serves as a powerful reminder of the role of social work research and practice to transform lives and improve conditions for individuals, families, and communities.

Our robust program includes paper presentations, innovation incubators, brief and brilliant sessions, special interest groups (SIGs), flash talks, plenaries, invited symposia, and much more. We are especially honored to welcome our Opening Plenary keynote speaker, Dr. Howard Koh, Harvey V. Fineberg Professor of the Practice of Public Health Leadership at Harvard University. Our Presidential Plenary will feature distinguished speakers including Mayor Keisha Lance Bottoms, former Mayor of Atlanta and Director of the White House Office of Public Engagement, and Dr. Holden Thorp, Editor-in-Chief of the Science family of journals.

This year marks SSWR's 30th conference anniversary. Your commitment, impactful research, and leadership have elevated the visibility and importance of social work science. Your presence is especially meaningful as we navigate a national climate where the value of higher education and the role of social work research are under scrutiny. Our mission-driven work remains steadfast, reaffirming the inherent worth and dignity of all people, illuminating the structural and systemic barriers to equity and justice, while also offering evidence-based solutions that promote healing, resilience, and opportunity. Through rigorous research, we not only deepen our understanding of complex social issues but also inform policies and practices that create lasting, transformative change. As scholars and practitioners, our commitment to advancing social work science ensures that our profession remains a powerful force for advocacy, innovation, and hope in communities across the globe.

I extend heartfelt thanks to our Conference Committee, led by SSWR Vice President Dr. Hyeouk "Chris" Hahm of Boston University, for curating four days of intellectually rich programming. We are also deeply grateful to Jennifer Lewis, A. DeeJay Hastings, Kristen Reamy, and Bill Haire and Shelley Riggs at Travelink for their exceptional logistical support which make this conference possible year after year.

This year's program also features the esteemed Aaron Rosen Lecture, jointly sponsored by SSWR and the Washington University in St. Louis, George Warren Brown School of Social Work, presented by Dr. Karen Fredriksen Goldsen, University of Washington, and the Social Policy Forum with Dr. Sandra Edmonds Crewe, Howard University and Dr. Charles Lewis, Congressional Research Institute for Social Work Policy. We encourage you to attend the Membership Business Meeting to hear updates on the Society's initiatives and to engage in dialogue about our future. Please also visit our website to receive an update about SSWR's 2024–2028 Strategic Directions.



**Ramona Denby-Brinson, PhD,
ACSW, LMSW**

Leading for Transformative Change: *Aligning Social Work Science with Policy and Practice*

Congratulations to our Distinguished Career Achievement Award recipient, Dr. Deborah K. Padgett, Professor; McSilver Faculty Fellow; Affiliated Faculty, Department of Anthropology and College of Global Public Health at New York University. The SSWR Board is proud to honor her groundbreaking scholarship and pioneering leadership, including her role as a former SSWR president.

We also extend our deepest appreciation to Jennifer Lewis, who concluded her service as SSWR Executive Director in December 2025. Jennifer's dedication and many contributions have been instrumental in establishing SSWR as the leading research society in our profession.

We are thrilled to introduce Valerie Arendt, SSWR's first full-time Executive Director. Valerie brings a wealth of experience in nonprofit leadership and advocacy for the social work profession. Under her guidance, we look forward to reaching new heights together.

The success of SSWR would not be possible without the ongoing support of our members, the leadership of social work education programs, and our valued partners—including the Council on Social Work Education, National Association of Social Workers, Association of Baccalaureate Social Work Program Directors, Group for the Advancement of Doctoral Education in Social Work, National Association of Deans and Directors, the Social Work Collective to Advance Research: Deans & Directors Group, the Grand Challenges for Social Work, and the American Academy of Social Work and Social Welfare.

Lastly, with deep gratitude to my fellow Board members, I conclude my service as President of SSWR. It has been an extraordinary honor to serve this remarkable community and to contribute to the advancement of our beloved profession. I am sincerely thankful for the opportunity to lead and to work alongside such dedicated and visionary colleagues.

To President-Elect, Dr. Kirk Foster, Dean and Professor at The University of Texas at Arlington, School of Social Work—there is no one more capable and better suited to carry forward this mantle. Your leadership and commitment to social work science inspire great confidence in what lies ahead. I look forward with great anticipation to the continued growth and impact of SSWR under your stewardship.

On behalf of the SSWR Board of Directors, thank you for your continued support and for joining us at this year's conference. We hope you find inspiration, connection, and renewed energy in the days ahead.

Warm regards,

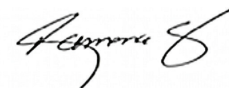

Ramona Denby-Brinson, PhD, ACSW, LMSW
SSWR President

Dean & Wallace H. Kuralt, Sr. Distinguished Professor of Public
Welfare Policy and Administration
University of North Carolina at Chapel Hill, School of Social Work





Community-engaged Research That Advances Social Change

At GSSW, faculty, students and community partners work together to advance social justice through rigorous, community-engaged research. We contribute significantly to the University of Denver's **national R1 standing**, generating knowledge that strengthens practice, informs policy and drives systems change.

Transformative Centers and Institutes

- + Center for Housing and Homelessness Research
- + Institute for Human-Animal Connection
- + Butler Institute for Families
- + Center for Equity Research
- + Cross-National Behavioral Health Laboratory

QUICK FACTS

**HIGHEST RESEARCH EXPENDITURES
ON THE DU CAMPUS IN 2024-25**

**FACULTY RANKED AMONG THE TOP
2% OF SCIENTISTS WORLDWIDE**

**MORE THAN 100 ACTIVE RESEARCH
PROJECTS ACROSS FACULTY,
CENTERS AND INSTITUTES**

**READ OUR LATEST
IMPACT REPORT**



Celebrating 30 Years of the SSWR Annual Conference: A Brief History

The Society for Social Work and Research (SSWR) emerged from a bold idea in the early 1990s: that social work scholars needed their *own* scientific society to advance rigorous research, build professional community, and strengthen the infrastructure for social work science. In 1994, SSWR was officially founded as a professional membership organization dedicated to supporting social work researchers.

SSWR Conference at 30 Years: Quick Facts About SSWR and the Annual Conference

- **Founded in 1994, SSWR was created to give social work researchers their own scientific society and professional home.**
 - **In 1995, the first annual conference** was launched by a small volunteer group with support from National Institute of Mental Health and the National Institute on Drug Abuse.
 - Conference attendance grew from **300 participants in 1998** to more than **2,200 in 2025**, reflecting the rapid expansion of social work research.
- SSWR created **nine annual awards** to recognize research excellence and emerging scholars.
 - In 2010, SSWR launched its peer-reviewed journal, the **Journal of the Society for Social Work and Research**, now published by the University of Chicago Press.
 - The conference played a central role in launching major field-defining efforts like the **Science of Social Work** movement.
 - SSWR hosted the **launch of the Grand Challenges for Social Work** at the 2016 conference, marking a major milestone in the profession.
 - Poster and paper sessions expanded dramatically in the 2010s, **doubling opportunities for scholars**, especially doctoral students and early career researchers.
 - In 2014, SSWR established the **Fellows Program** to honor members with sustained contributions to the society and the advancement of social work research.
 - Today, the conference is the **leading global venue** for advancing social work science, shaping policy-relevant research, and supporting the next generation of scholars.

Looking Ahead: SSWR Conference at 30 Years

Now celebrating its 30th annual conference anniversary, the SSWR Annual Conference stands as the premier global gathering for social work researchers, an essential space for discovering new knowledge, strengthening methods, mentoring the next generation, and advancing solutions to society's most urgent challenges. The conference's history reflects not only SSWR's growth, but the evolution of social work research itself into a robust, multidisciplinary scientific enterprise.

Thank you for joining us to celebrate the best of social work research and the science that fuels innovation, strengthens our profession, and drives meaningful change toward a more just, healthy, and equitable society.





Graduate College of Social Work
UNIVERSITY OF HOUSTON

MEET OUR DEAN

Yarneccia D. Dyson, Ph.D., MSW
Maconda Brown O'Connor Endowed Dean's Chair

WWW.UH.EDU/SOCIALWORK



2026 Exhibitors

The following institutions/organizations are exhibiting in the Marquis BR, ML 2, Marriott Marquis Washington, DC hotel. Be sure to visit each of them Thursday 1:30pm-7:30pm; Friday 8:00am-6:45pm; and Saturday 8:00am-12:00pm. For your convenience, they are listed alphabetically with the booth number.

AllCampus	302
Arizona State University	300
Child Welfare Information Gateway	505
Council on Social Work Education (CSWE)	503
Critical Memory Integration (CMI)	405
Fordham University	205
Future of Families and Child Wellbeing Study	303
Grand Challenges for Social Work	507
Howard University School of Social Work	500
National Longitudinal Surveys	305
NC State University	404
Oxford University Press	204
Rutgers School of Social Work	102
Sacred Heart University, School of Social Work	506
Silberman School of Social Work at Hunter College	101
Simmons University School of Social Work	401
Simucase	201
The Quality Improvement Center on Engaging Youth in Finding Permanency	304
The University of Alabama School of Social Work	104
UH Graduate College of Social Work	301
University of Chicago Press	502
University of Denver Graduate School of Social Work	504
University of Georgia School of Social Work	103
University of Illinois	200
University of Louisville, Kent School of Social Work and Family Science	203
University of Michigan School of Social Work	202
University of North Carolina at Chapel Hill	100
University of Pittsburgh School of Social Work	501
University of Tennessee, College of Social Work	403
University of Texas at Arlington - School of Social Work	402
University of Washington	105
WashU Brown School	400

PROUD CO-SPONSORS OF SSWR 2026 ANNUAL CONFERENCE



As the first university-based social work school in the United States, Columbia has played a pivotal role in educating generations of changemakers, and leading research that shapes policy, and practice.

With 125+ years of leadership in transformative social work education, CSSW prepares practice-ready change-makers. Explore our full-time pathways, 2-Year, Transfer, Advanced Standing, and 5-Term, or choose flexible part-time options (rolling while space permits).

Columbia's future in social work is built on the same foundation that has sustained it for more than a century: a fierce belief in human potential and a responsibility to shape a more just, compassionate world.

Fall 2026 deadlines:

- Priority – December 1 (11:59 PM)
- Second – February 15 (11:59 PM)
- Final – April 1 (11:59 PM)



Apply Today.

Columbia School of Social Work
1255 Amsterdam Avenue
New York, NY 10027-5927

✉ cssw-admit@columbia.edu

🌐 socialwork.columbia.edu

☎ 1-212-851-2400

☎ Toll free: 1-855-532-5200



Program Overview

Wednesday – January 14, 2026

4:00 pm– 8:00 pm Registration Open

Mezzanine Foyer, Mezzanine Level

Thursday – January 15, 2026

7:30 am– 7:00 pm Registration Open

Marquis BR Foyer, ML 2

7:30 am– 1:00 pm **SSWR RCDC Research, Inspire, Support, and Excel (RISE) Seminar** *Monument, ML 4*

(by invitation only)

Organizers: Greer Hamilton, PhD, University of Michigan; Qiana Cryer-Coupet, PhD, Georgia State University

Sponsored by University of Michigan, School of Social Work



8:00 am–12:00 pm **Research Methods Workshops** (separate fee required)

8:00 am–12:15 pm **Special Sessions on Research Priorities & Capacity Building** (separate fee required)

12:15 pm– 1:30 pm **“Meet the Scientist” Luncheon** (separate fee required) *Shaw, ML 3*

Welcome and Introductions: Justin Harty, PhD, Arizona State University; Fatima Mabrouk, MSW, New York University

Scholars: Raymond Adams, PhD, Morgan State University; Shanondora Billiot, PhD, Arizona State University; Robert Cosby, PhD, Howard University; Megan Finno-Velasquez, PhD, New Mexico State University; Sam Harrell, PhD, Seattle University; Amy He, PhD, University of Denver; Daniel López, PhD, Boston University; Keiana Mayfield, PhD, George Mason University; Marcela Nava, PhD, University of Texas at Arlington; Kristel Scoresby, PhD, University of Kentucky

Sponsored by University of Georgia, School of Social Work



12:30 pm– 1:30 pm **Social Policy Committee Current Events Session:** *Independence BR D/E, ML 4*

Crisis and Responsibility: Social Work’s Ethical Imperative in Today’s Policy Landscape*

Chair: Donte Boyd, PhD, University of Houston

*presented in person and live streamed

12:30 pm– 1:30 pm Lunch On Your Own

1:30 pm– 3:00 pm Flash Talks / Symposia / Workshops / Roundtables / Paper Presentations / ePosters

1:30 pm– 7:30 pm Exhibits Open

Marquis BR, ML 2

3:15 pm– 4:45 pm Flash Talks / Symposia / Workshops / Roundtables / Paper Presentations / ePosters

5:00 pm– 6:30 pm **Opening Plenary***

Land Acknowledgment Ceremony

Independence BR D/E, ML 4

Welcome and Introductions: Hyeouk “Chris” Hahm, PhD, Boston

University, SSWR Vice President and 2026 Conference Chair

Keynote Speaker: Howard Koh, MD, MPH, Harvard University

Sponsored by Boston College, School of Social Work



BOSTON COLLEGE
School of Social Work



Howard Koh, MD, MPH

6:30 pm– 7:30 pm **Opening Reception**

Marquis BR, ML 2

Sponsored by The University of Oklahoma, Anne and Henry Zarrow School of Social Work



DODGE FAMILY COLLEGE OF ARTS AND SCIENCES
ANNE AND HENRY ZARROW
SCHOOL OF SOCIAL WORK
The UNIVERSITY of OKLAHOMA

7:30 pm– 9:30 pm **Student Social Hour – all students are welcome!**

Shaw, ML 3

Host: Fatima Mabrouk, MSW, New York University, SSWR Student Director-at-Large



*presented in person and live streamed

Friday – January 16, 2026

7:00 am – 8:00 am **Special Interest Group (SIG) Meetings I**

7:30 am – 4:00 pm Registration Open

Marquis BR Foyer, ML 2

8:00 am – 9:30 am Flash Talks / Symposia / Workshops / Roundtables / Paper Presentations / ePosters

8:00 am – 6:45 pm Exhibits Open

Marquis BR, ML 2

9:45 am – 11:15 am **RCDC Research Roots & Wings Roundtable I: Funding and Political Realities: Navigating Uncertainty as an Early Career Scholar**

Capitol, ML 4

Co-Chairs: Bernadine Waller, PhD, Columbia University; Durrell Washington, Sr., PhD, Rutgers University; Speakers: Robert O. Motley, Jr., PhD, Boston College; Waldo E. Johnson, PhD, The University of Chicago; Jenny Jones, PhD, Clark Atlanta University; Trenette Clark Goings, PhD, University of North Carolina at Chapel Hill

[Sponsored by Group for the Advancement of Doctoral Education in Social Work](#)



9:45 am – 11:15 am Flash Talks / Symposia / Workshops / Roundtables / Paper Presentations / ePosters

11:30 am – 12:30 pm **Aaron Rosen Lecture**

Independence BR D/E, ML 4

Crisis to Catalyst: Mobilizing Gender and Sexuality Science to Ignite Lifelong Health and Inspire a Transformative Social Work Future*

Keynote Speaker: Karen Fredriksen Goldsen, PhD, University of Washington

[Jointly sponsored by the Society for Social Work and Research \(SSWR\) and the Brown School of Social Work, Washington University in St. Louis](#)



Karen Fredriksen Goldsen, PhD



*presented in person and live streamed

12:30 pm– 1:30 pm **SSWR Fellows and Cluster Chairs Service Appreciation Luncheon (by invitation only)** *Liberty BR L/M, ML 4*

12:45 pm– 1:45 pm Lunch On Your Own

12:45 pm– 1:45 pm **Special Interest Group (SIG) Meetings II**

2:00 pm– 3:30 pm **Invited Symposium I: Advancing Inclusive Economic Security across the Life Course: Research and Policy Pathways Forward*** *Independence BR D/E, ML 4*

Moderator: Judith G. Gonyea, PhD, Boston University

Panelists: Lawrence Berger, PhD, University of Wisconsin-Madison; Stephen Crystal, MA, PhD, Rutgers University; Yoonsook Ha, PhD, Boston University; Jennie Romich, PhD, University of Washington; Margaret M. C. Thomas, PhD, The University of Chicago

[Sponsored by Boston University, School of Social Work](#)



Boston University School of Social Work

2:00 pm– 3:30 pm Flash Talks / Symposia / Workshops / Roundtables / Paper Presentations / ePosters

3:45 pm– 5:15 pm **Special Session: Journal of the Society for Social Work and Research (JSSWR)** *Marquis BR 10, ML 2*

Chair and Speaker: Todd I. Herrenkohl, PhD, University of Michigan-Ann Arbor, JSSWR Editor-in-Chief

Speakers: Tamara Cadet, PhD, University of Pennsylvania; Bryan Victor, PhD, Wayne State University; Lauri Goldkind, PhD, Fordham University; Brian Perron, PhD, University of Michigan-Ann Arbor

3:45 pm– 5:15 pm **Brief and Brilliant Session: "I dream a world..."*** *Independence BR D/E, ML 4*

Organizers and Moderators: Shannon Sliva, PhD, University of Denver; Caroline Sharkey, PhD, University at Albany; Presenters: Trina Nurse, DSW, Columbia University; Kiley McLean, PhD, University of Wisconsin-Madison; Joanna La Torre, PhD(c), LCSW, University of Washington; Ahmed Alif, MS, New York University; Courtney Hutchison, PhD, University of Pennsylvania; Kristine Heflin, MSW, Uniformed Services University of the Health Sciences

[Sponsored by University of Denver, Graduate School of Social Work](#)

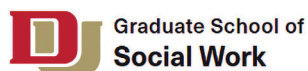

*presented in person and live streamed

Leading for Transformative Change: *Aligning Social Work Science with Policy and Practice*

- 3:45 pm– 5:15 pm **Invited Journal Editors' Workshop: Forum on Publishing Qualitative Research** *Marquis BR 12, ML 2*
Chair: Jane Gilgun, PhD, University of Minnesota-Twin Cities; Speakers: Johanna Creswell Baez, PhD, University of Colorado, Colorado Springs; Mery Diaz, PhD, New York City College of Technology; Robert Hawkins, PhD, University of North Carolina at Chapel Hill; Lisette Piedra, PhD, LCSW, University of Illinois at Urbana-Champaign; Susan Robbins, PhD, University of Houston; Cristina Wilson, PhD, University of Connecticut
- 3:45 pm– 5:15 pm Flash Talks / Symposia / Workshops / Roundtables / Paper Presentations / ePosters
- 5:30 pm– 7:00 pm Flash Talks / Symposia / Workshops / Roundtables / Paper Presentations / ePosters

Saturday – January 17, 2026

- 7:00 am– 8:00 am **Special Interest Group (SIG) Meetings III**
- 8:00 am– 2:00 pm Registration Open *Marquis BR, ML 2*
- 8:00 am– 9:30 am Flash Talks / Symposia / Workshops / Roundtables / Paper Presentations / ePosters
- 8:00 am–12:00 pm Exhibits Open *Marquis BR, ML 2*
- 9:45 am–11:15 am **Invited Symposium II: Advancing Health and Social Equity Through Artificial Intelligence*** *Independence BR D/E, ML 4*
Moderator: Hyeouk "Chris" Hahm, PhD, Boston University
Panelists: Ruopeng An, PhD, New York University; Desmond Patton, PhD, University of Pennsylvania; Cheng Ren, PhD, University at Albany, State University of New York; Hee Yun Lee, PhD, University of Georgia; Jacky Gong, PhD, University of Alabama
[Sponsored by Boston University, School of Social Work](#)



Boston University School of Social Work

*presented in person and live streamed

9:45 am–11:15 am Flash Talks / Symposia / Workshops / Roundtables / Paper Presentations / ePosters

11:30 am–12:30 pm **Annual Social Policy Forum***

Independence BR D/E, ML 4

Keynote Speakers: Sandra Edmonds Crewe, MSW, PhD, ACSW, Howard University;
Charles E. Lewis, Jr., MSW, PhD, Congressional Research Institute for Social Work and Policy



Sandra Edmonds Crewe, MSW, PhD, ACSW



Charles E. Lewis, Jr., MSW, PhD

Sponsored by Boston University, School of Social Work



Boston University School of Social Work

12:30 pm– 1:30 pm Lunch On Your Own

12:30 pm– 1:30 pm **Special Interest Group (SIG) Meetings IV**

12:30 pm– 1:45 pm **Student Session and Luncheon: Resisting Erasure: Upholding Social Work Ethics Amid Censorship and State Violence Against DEI advocates, Immigrant, and LGBTQ+ Communities*** *Liberty BR L/M, ML 4*

Chair: Fatima Mabrouk, MSW, New York University

Speakers: Autumn BlackDeer, PhD, University of Denver; Leslie Hall, PhD, American University; Laurie Heffron, PhD, St. Edwards University; Shanna K. Kattari, PhD, University of Michigan-Ann Arbor

12:45 pm– 1:45 pm **Grand Challenges for Social Work Roundtable: Introduction to the Social Work Grand Challenges Futures Project (2025-2026)** *Independence BR D/E, ML 4*

Chair: Carrie Pettus, PhD, Justice System Partners

2:00 pm– 2:30 pm **Fellows and Awards Presentations*** *Independence BR D/E, ML 4*

Presenters: Ramona Denby-Brinson, PhD, MSW, SSWR President; Joan Blakey, PhD, University of Minnesota-Twin Cities, SSWR Awards Committee Chair

*presented in person and live streamed

Leading for Transformative Change: *Aligning Social Work Science with Policy and Practice*

2:45 pm – 4:00 pm **Presidential Plenary***

Independence BR D/E, ML 4

Welcome and Introductions: Ramona Denby-Brinson, PhD, MSW, University of North Carolina at Chapel Hill, SSWR President

Speakers: Holden Thorp, PhD, George Washington University; Keisha Lance Bottoms, Mayor of Atlanta (2018-2022); Director of the White House - Office of Public Engagement (2022-2023)



Holden Thorp, PhD



Mayor Keisha Lance Bottoms

Sponsored by Case Western Reserve University, Jack, Joseph, and Morton Mandel School of Applied Social Sciences



**CASE WESTERN RESERVE
UNIVERSITY**
Jack, Joseph and Morton Mandel
School of Applied Social Sciences

4:15 pm – 5:45 pm **Invited Symposium III: Task Force on Safeguarding Social Work Research: A Dialogue and Strategic Response to Emerging Threats***

Independence BR D/E, ML 4

Moderator: Fatima Mabrouk, MSW, New York University

Panelists: Mary Ohmer, PhD, University of Pittsburgh; Justin Harty, PhD, Arizona State University; Cheryl Hyde, PhD, Temple University

Sponsored by University of Georgia, School of Social Work



**UNIVERSITY OF
GEORGIA**
School of Social Work

*presented in person and live streamed

4:15 pm– 5:45 pm **RCDC Research Roots & Wings Roundtable II: Federal Funding, Historical Context, and Equity-Focused Research Navigating Past Foundations and Future Directions** *Marquis BR 12, ML 2*

Co-Chairs: Mo Yee Lee, PhD, The Ohio State University; Fatima Mabrouk, MSW, New York University; Speakers: Mimi Chapman, PhD, The University of North Carolina at Chapel Hill; Michael Spencer, PhD, University of Washington; Elizabeth Lightfoot, PhD, Arizona State University; Jerome Schiele, PhD, Morgan State University; Martell Teasley, PhD, University of Utah

Sponsored by University of Washington,
School of Social Work



4:15 pm– 5:45 pm Flash Talks / Symposia / Workshops / Roundtables / Paper Presentations / ePosters

6:00 pm– 6:30 pm **Membership Business Meeting*** *Independence BR D/E, ML 4*

Chair: Ramona Denby-Brinson, PhD, MSW, University of North Carolina at Chapel Hill, SSWR President

Sponsored by University of Houston,
Graduate College of Social Work



6:30 pm– 7:30 pm **President's Reception** *Liberty BR L/M, ML 4*

Musical Performance by Howard University Jazz Ensemble

7:45 pm– 9:45 pm **American Academy of Social Work and Social Welfare (AASWSW) New Fellows Induction Ceremony and Reception** *Independence BR D/E, ML 4*

Sunday – January 18, 2026

7:45 am–11:00 am Registration Open *Marquis BR Foyer, ML 2*

8:00 am– 9:30 am Flash Talks / Symposia / Workshops / Roundtables / Paper Presentations / ePosters

9:45 am–11:15 am Flash Talks / Symposia / Workshops / Roundtables / Paper Presentations / ePosters

11:30 am– 1:00 pm Flash Talks / Symposia / Workshops / Roundtables / Paper Presentations / ePosters

1:00 pm Conference Ends

*presented in person and live streamed

Health and Safety

We are looking forward to your participation in the Society for Social Work and Research's 2026 conference in Washington, DC. SSWR's first priority is the safety and welfare of our attendees, exhibitors, partners, contractors, and staff. We hope this policy will help keep everyone safe and comfortable.

This policy is informed by guidance and recommendations issued by the U.S. Centers for Disease Control and Prevention (CDC) and other public health authorities. We will continue to monitor and update SSWR's health and safety policy as needed.

Here is what you should know:

Masks are NOT required and there is no COVID-19 vaccination status requirement.

The Marriott Marquis Washington DC reports that it is back to regular day-to-day cleaning, with its continued focus on cleanliness in public space areas and guest rooms, with updated Ecolab products. There will be hand sanitizer stations and regularly clean public space, but it is not to the level that was done during peak pandemic. Housekeeping offers full service in guest rooms more regular than peak-COVID as well, and guests will have the option to forgo Housekeeping services with Do Not Disturb sign on door.

SSWR Anti-Harassment Policy

The Society for Social Work Research advances, disseminates, and translates research that addresses issues of social work practice and policy and promotes a diverse, just, and equitable society. As a social work professional organization, SSWR shares and is committed to acting in accordance with our profession's values and its code of ethics. Therefore, any form of harassment will be considered professional misconduct and will be taken seriously.

SSWR Land Acknowledgment

In the spirit of healing, we would like to acknowledge and honor the lands of the Nacotchtank (Anacostan) Peoples in what is now the Washington DC area; also the lands in what is now Northern Virginia in the territory of the Doeg (Tauxenent) People who had their main village site just north of Aquia Creek, and other sites of Miompse at Mason Neck, Virginia, Quantico Creek (Pamacocack), Powell's Creek (Yosococomico), and Neabsco Creek (Nipsco). We also acknowledge and honor other Algonquian Peoples of this territory- the Kinjawa Pasketikweya or Piscataway Conoy on the Maryland side.

► Admission to Conference Activities

You **MUST** wear your conference nametag to be admitted to all program sessions, e.g. workshops, symposia, oral papers, poster presentations, and the exhibit hall. The Conference Registration Desk will be open throughout most of the conference. Admission to all award presentations and receptions also requires your nametag. Please drop by the Conference Registration Desk located in Marquis Ballroom Foyer, Meeting Level 2, Marriott Marquis Washington, if you would like to register your spouse/guest to attend a reception. Spouse/guest(s) who would like to attend presentations/sessions are required to pay the full conference registration fee.

► Continuing Education Units (CEUs)

The SSWR workshops, papers, symposia, plenary sessions, and all Thursday morning research methods workshops and special sessions on research priorities and capacity building meet requirements for continuing education units (CEUs) for social workers approved by the National Association of Social Workers (NASW). Please note, however, that not all states accept NASW-approved CEUs. We **strongly** advise you to check with the organization that is responsible for your state licensing that NASW-approved CEUs are acceptable by your state. To receive CEUs, your evaluation of EACH session that you attended must be completed and submitted via the 2025 Conference App. Download the 2026 Conference App at http://www.core-apps.com/dl/sswr_conferences. **To submit your evaluation, you must first create a profile on the app (name and email address will be needed)**, find the session on the app, click on the Clipboard icon, answer the evaluation questions and click Submit/Save. You must submit your responses 5 minutes before the session ends through 10 minutes

after the session. Staff will review your evaluation ratings and confirm your CEUs post-conference. No partial credit will be awarded – participants must remain through entire sessions to receive credit. The number of CEUs is dependent on the number of sessions attended at the meeting. Please note it is NASW policy that oral paper presenters, workshop speakers, symposium organizers and symposium discussants, and symposium paper presenters may not receive credit from the session in which they are participating. There is a \$25 CEU certificate fee (non-refundable) to cover costs incurred by SSWR and NASW. CEU certificates will be emailed to you by SSWR a minimum of eight (8) weeks after the conference has concluded. No CEU forms will be available or accepted after the conference ends.

► ADA Assistance

Any attendees who desire ADA assistance with accessing or participating in conference activities should provide such requests to the staff at the Conference Registration Desk. Please do so at the earliest opportunity so that necessary arrangements can be made. Hearing impaired requests must have been submitted prior to December 1, 2025, in order to make arrangements for interpretive services. In the Independence Ballroom D-E, ML 4, a closed caption screen will be located near the stage.

► Wi-Fi Access

The Marriott Marquis Washington DC Hotel provides complimentary Wi-Fi in its lobby and public areas. Attendees who make their reservations through SSWR's website or call the Marriot Marquis Washington DC Hotel are eligible to receive free Guest Room internet as long as SSWR occupies 80% of its contracted room block. SSWR is providing complimentary Wi-Fi access in the meeting rooms. The password is UConnSSW.

► Conference Mobile APP

The Conference Mobile APP (hosted by Core-Apps) enables participants to search or browse presentations/sessions and speakers, create their itinerary of sessions and events to attend and integrate to their calendar, and complete CEU evaluations (see page 20 for CEU information). Directions on how to pinpoint the various locations of all conference events is also available within the app. You will also be able to hashtag the SSWR 2026 conference via X (formerly Twitter) using #SSWR26. To download the Conference Mobile App, plug http://www.core-apps.com/dl/sswr_conferences into your mobile device's browser for either Apple or Google Play stores. This link will automatically detect your mobile type and take you to the right place to download the app. If you have any questions or need technical assistance, click on the 'get support' within the "about app" icon on the mobile app dashboard.

► Parents' Nursing Room

A parents' nursing room is available in the hotel. Please check in at the Membership Desk for access.

► "Quiet" Room

A "Quiet" Room is available for prayer, meditation, and reflection. This room may be reserved upon request at the Membership Desk.

► Gender Inclusive Restrooms

A gender inclusive restroom is available in the hotel. Please check for signage in the registration area for its location and/or inquire at the Student Volunteer Help Desk.

► Name Badges and Pronouns

If you would like to add pronouns to your name badge, please stop by the registration area and pick up a pronoun ribbon which you can put on your name badge.

► Photo and Video Release Statement & Agreement

From time to time, SSWR will take photos and videos of conference events and reserves the right to use these photographs and videos in its promotional materials. Unless this permission is revoked in writing to SSWR, by virtue of their attendance all conference participants agree to the use of their likeness in such materials.

The wifi is sponsored by the University of Connecticut and the passcode is: UConnSSW

UConn
SCHOOL OF SOCIAL WORK

Silberman
School of Social Work

HUNTER
The City University of New York



EXCELLENCE IN SOCIAL WORK RESEARCH

The Silberman School of Social Work at Hunter College proudly recognizes the contributions of our outstanding faculty at the 2026 SSWR Conference. You exemplify Silberman's legacy of social work research excellence.

Congratulations!



Dr. Bianca De Bellis



Dr. Ari Gzesh



Dr. Rong Zhao



Dr. Marina Lalayants



Dr. Qi Chen



Dr. James Mandiberg



Ian Williams



Dr. Vicki Lens



Dr. Seon Mi Kim



Dr. Mohamad Adam Brooks



Dr. Jama Shelton



Dr. Liat Shklarski



Dr. Keith Chan

 University at Buffalo
School of Social Work

Social work is vital

and our research
makes life better

**EXPLORE
HOW**



Research Methods Workshops (requires separate registration)

These research methodology workshops provides training opportunities to build your research methods tools and skill-sets.

Thursday - January 15, 2026

8:00 am – 12:00 pm

RMW-1 **AI in Action: Leveraging Agents, Mastering Prompt Engineering, and Securing Grants for Breakthrough Impact** *Marquis BR 7, ML 2*

Presenters: Hee Yun Lee, PhD, University of Georgia; Ruopeng An, PhD, New York University; Jiaqi “Jackey” Gong, PhD, University of Alabama

Sponsored by [The Ohio State University, College of Social Work](#)



THE OHIO STATE UNIVERSITY
COLLEGE OF SOCIAL WORK

RMW-2 **Transformational Skills for Healthy, Sustainable Writing Productivity** *Marquis BR 8, ML 2*

Presenter: Rich Furman, PhD, University of Washington, Tacoma

RMW-3 **Spatial Data Science: Visualizing and Analyzing Community Needs** *Marquis BR 9, ML 2*

Presenters: Woojin Jung, PhD, MSW, MPP, Rutgers University; Andrew. H. Kim, MSW, LCSW, LCADC, Rutgers University; Vatsal Shah, BS, Rutgers University

Sponsored by [Rutgers University, School of Social Work](#)



RUTGERS UNIVERSITY
School of Social Work

RMW-4 **Demystifying Implementation Science: Strategies for Real-World Research and Intervention Impact** *Marquis BR 10, ML 2*

Presenters: Deborah Moon, PhD, MA, LCSW, University of Pittsburgh; Byron Powell, PhD, Washington University in St. Louis; Leah Jacobs, PhD, University of Pittsburgh

Sponsored by [The University of Tennessee Knoxville, College of Social Work](#)



THE UNIVERSITY OF
TENNESSEE
KNOXVILLE

COLLEGE OF SOCIAL WORK

Special Sessions on Research Priorities and Capacity Building (SSRPCB) (requires separate registration)

These training-oriented sessions target cutting-edge topics vital to contemporary social work research.

Thursday - January 15, 2026

8:00 am – 10:00 am

SSRPCB-1 Nuts and Bolts of Art-Based Research, Education, & Practice *Supreme Court, ML 4*
Presenter: Rogério Pinto, PhD, University of Michigan

SSRPCB-2 How Researchers Can Move the Needle for Policy Change *Marquis BR 13, ML 2*
Presenters: Rebekah Gewirtz, LICSW, NASW, Massachusetts and Rhode Island Chapters
Sponsored by University of Wisconsin Milwaukee, Helen Bader School of Social Welfare



Helen Bader School
of Social Welfare

10:15 am – 12:15 pm

SSRPCB-4 The Good, the Challenging, and the Discouraging Aspects of the K Series: Navigating NIH K Career Awards in Social Work *Marquis BR 14, ML 2*
Presenters: Carolina Vélez-Grau, PhD, LCSW, Boston College; Liwei Zhang, PhD, University of Georgia; Genevieve Graaf, PhD, University of Texas Arlington; Meghan Romanelli, PhD, LCSW, University of Washington; Fernanda Cross, PhD, University of Michigan

SSRPCB-5 Historical Research Methods for Advancing Antiracist and Anticolonialist Social Work Research *Marquis BR 13, ML 2*
Presenters: Justin S. Harty, PhD, Arizona State University; Jane McPherson, PhD, University of Georgia; Bethany Jo Murray, PhD, University of California Los Angeles; Jerome Schiele, DSW, Morgan State University; Jessica Toft, PhD, University of Minnesota
Sponsored by University of Georgia, School of Social Work



**UNIVERSITY OF
GEORGIA**
School of Social Work



University of
Pittsburgh | School of
Social Work

University of Pittsburgh

SOCIAL WORK RESEARCH

- **GROUNDED**
in Community
- **CHALLENGING**
Oppressive Systems
- **REIMAGINING**
Policy and Practice

socialwork.pitt.edu



75TH ANNIVERSARY

UNIVERSITY OF TEXAS
SCHOOL OF
SOCIAL WORK

RIGOR IN RESEARCH INNOVATORS IN BEHAVIORAL HEALTH EXCELLENCE IN EDUCATION



The University of Texas at Austin
School of Social Work

Here's our **Strategic Plan**
for the years to come.



Making change happen since 1942.

- Top **25** graduate school
- **4** Degree Programs
- **4** Research Centers
- **7** Endowed Professors
- **\$27M** in New External Grant Funding



THE UNIVERSITY OF
TENNESSEE
KNOXVILLE 

COLLEGE OF SOCIAL WORK

Knoxville | Nashville | Online



**Celebrating
90 Years
of Impact
Through
Education,
Research
and Service.**

UNIVERSITY OF
LOUISVILLE

RAYMOND A. KENT
SCHOOL OF SOCIAL
WORK & FAMILY SCIENCE

**Congratulations to Our 2026
SSWR Conference Presenters:**

Dr. Becky Antle • Mackenzie Antle • Dr. Anita Barbee • Andreana Bridges
Dr. Karlynn BrintzenhofeSzoc • Yuqing Chen • Dr. Crystal Collins-Camargo
Garrett Hardy • Dr. Ashley Logsdon • Dr. Jennifer Middleton • Dr. Lizzie Minton
Dr. Heehyul Moon • Dr. Janet Otachi • Dr. Sunshine Rote • Sadaf Sedaghatshoar
Kathryn Williams Sites • Dr. Heather Storer • Kathryn Tillett
Dr. Camie Tomlinson • Liz Utterback • Dr. Andrew Winters • Dr. Lixia Zhang

*During the conference
stop by booth #203 to
visit with our presenters.*

Connect with us.



louisville.edu/kent

BOSTON UNIVERSITY SCHOOL OF SOCIAL WORK CONGRATULATES PROFESSOR HYEOK (CHRIS) HAHM

BOSTON
UNIVERSITY



**SSWR VICE PRESIDENT &
2026 CONFERENCE CHAIR**

AND WELCOMES NEW FACULTY



DR. ALLYALA NANDAKUMAR

Internationally recognized health economist and global policy expert joins BUSSW as a research professor and becomes Global Social Work and Public Health Lab director at the School's Center for Innovation in Social Work and Health. Dr. Nandakumar leads the groundbreaking Economic Value in Social Work Health Equity project.



DR. NOOR TORAI (PHD'23)

Dr. Toraif joins BUSSW as assistant professor of Macro Practice and utilizes mixed methods and community-engaged research centered at the nexus of the child welfare, juvenile, and criminal legal systems. Her research draws from developmental and sociolegal theories to understand youth and young adults' experiences in the U.S. child welfare, juvenile, and criminal legal systems.



bu.edu/ssw



Journal of the Society for Social Work & Research



Add a print subscription to your SSWR membership for only \$27 to receive four print issues per year in addition to your online journal access and free e-Book edition downloads.

journals.uchicago.edu/jsswr

The *Journal of the Society for Social Work and Research (JSSWR)* is a peer-reviewed publication dedicated to dissemination of innovative interdisciplinary research on social problems, methodological advances, and programs, interventions, and policies that contribute to meaningful and actionable social change.



THE UNIVERSITY OF CHICAGO PRESS JOURNALS

Our
**scholars
make an
impact**

 **UNC** | **SCHOOL OF
SOCIAL WORK**



Scan for more in-depth information about the collaborative impact of our research and community engagement.

sswimpactreport.unc.edu

**Home of
New Leaders**



**Home of Two
National
Presidents**



**Home of Two
National Journal
Editors-in-Chief**



ERIC RICE

Associate Dean for Research and Faculty Development

2021 American Academy of Social Work and Social Welfare Fellow

- 200 peer-reviewed articles
- Funded by the National Institute of Mental Health and Army Research Office
- Served as the principal investigator, co-principal investigator or project director on 12 grants

MIMI CHAPMAN

Associate Dean for Doctoral Education

Frank A. Daniels Distinguished Professor for Human Service Policy Information

President, Group for the Advancement of Doctoral Education in Social Work

RAMONA DENBY-BRINSON

Dean

Wallace H. Kuralt, Sr. Distinguished Professor of Public Welfare Policy and Administration

President, Society for Social Work and Research

ROBERT HAWKINS

Vice Dean

Editor-in-Chief, Social Work Research

LISA ZERDEN

John A. Tate Early Career Scholar for Children in Need

Editor-in-Chief, Social Work



THE UNIVERSITY
of NORTH CAROLINA
at CHAPEL HILL

SSW.UNC.EDU



FORDHAM

Graduate School
of Social Service



**SHAPE THE WORLD
FOR GOOD.**

**FORDHAM UNIVERSITY
MASTER OF SOCIAL WORK**

- **CAMPUS LOCATIONS**
Manhattan | Westchester | Long Island | Online
- **\$700K+ SCHOLARSHIPS PER YEAR**
- **FULL- AND PART-TIME STUDY OPTIONS**
- **WEEKEND & EVENING COURSES**



SCHOOL OF
SOCIAL WORK
UNIVERSITY OF MICHIGAN

Reach out. Raise Hope. Change Society.

We are proud of those in our community who are presenting at this year's conference and furthering the reach of social work research.

Welcome New Faculty



Katie Edwards
Professor of Social Work



Tara Maudrie
Assistant Professor
of Social Work



Connie Sung
Annmarie Hawkins Research
Professor in Disability Justice



Nari Yoo
Assistant Professor
of Social Work

Exciting New Program

The U-M School of Social Work is proud to announce a new program starting in Fall 2026! **The Master of Arts in Social Impact Leadership** is designed for changemakers ready to drive meaningful transformation across public, nonprofit, and private sectors.

ssw.umich.edu

For information
or to apply:



UConn

SCHOOL OF SOCIAL WORK

KNOWLEDGE
FOR JUSTICE

Top 9%

Ranked Among Graduate
Social Work Programs Nationwide
by U.S. News & World Report

\$23.5M

Research and Sponsored
Programs Expenditures FY25

\$1.5M

Student Scholarship
Funding

Accompaniment in Action

Our faculty translates social work science into practice interventions with communities and systems to tackle complex social problems. We co-create evidence and interventions in research-practice partnerships. We accompany in action.



BOSTON COLLEGE
School of Social Work



2026 SSWR SPONSORS

The Society for Social Work and Research is grateful to the following schools and organizations for their generous support of the Society and the SSWR 2026 Annual Conference.

Platinum Level Sponsors – \$20,000

 <p>BOSTON COLLEGE School of Social Work</p>	<p>Thursday Opening Plenary, Sole Sponsor</p>
 <p>Boston University School of Social Work</p>	<p>Social Policy Forum, Sole Sponsor Invited Symposium I: <i>Advancing Inclusive Economic Security across the Life Course: Research and Policy Pathways Forward</i>, Sole Sponsor Invited Symposium II: <i>Advancing Health and Social Equity Through Artificial Intelligence</i>, Sole Sponsor</p>
 <p>CASE WESTERN RESERVE UNIVERSITY Jack, Joseph and Morton Mandel School of Applied Social Sciences</p>	<p>Presidential Plenary, Sole Sponsor</p>
 <p>UNIVERSITY OF GEORGIA School of Social Work</p>	<p>ePosterboards, Sole Sponsor Meet the Scientist Luncheon, Sole Sponsor Invited Symposium III: <i>Task Force on Safeguarding Social Work Research: A Dialogue and Strategic Response to Emerging Threats</i>, Sole Sponsor SSRPCB-5: <i>Historical Research Methods for Advancing Antiracist and Anticolonialist Social Work Research</i>, Sole Sponsor</p>
 <p>SCHOOL OF SOCIAL WORK UNIVERSITY OF MICHIGAN</p>	<p>SSWR Research Capacity Development Committee (RCDC) Research, Inspire, Support, and Excel (R.I.S.E.) Seminar, Sole Sponsor</p>
 <p>SCHOOL OF SOCIAL WORK</p>	<p>Welcome Flash Page Conference Mobile App, Sole Sponsor</p>

2026 SSWR SPONSORS

Gold Level Sponsors – \$10,000

 <p>THE UNIVERSITY OF CHICAGO CROWN FAMILY SCHOOL OF SOCIAL WORK, POLICY, AND PRACTICE Advancing a More Just and Humane Society</p>	Hotel Guest Room Key Cards, Sole Sponsor
 <p>UTA School of Social Work</p>	Conference Lanyards, Sole Sponsor
 <p>TEXAS Social Work The University of Texas at Austin Steve Hicks School of Social Work</p>	General Support
 <p>UCONN SCHOOL OF SOCIAL WORK</p>	Conference Wi-Fi, Sole Sponsor
 <p>Graduate College of Social Work UNIVERSITY OF HOUSTON</p>	Membership Business Meeting, Sole Sponsor Coffee Break, Co-Sponsor

Silver Level Sponsors – \$5,000

 <p>NYU SILVER SCHOOL OF SOCIAL WORK</p>	General Support, Co-Sponsor
 <p>THE OHIO STATE UNIVERSITY COLLEGE OF SOCIAL WORK</p>	General Support, Co-Sponsor RMW I: <i>AI in Action: Leveraging Agents, Mastering Prompt Engineering, and Securing Grants for Breakthrough Impact</i> , Sole Sponsor
 <p>DODGE FAMILY COLLEGE OF ARTS AND SCIENCES ANNE AND HENRY ZARROW SCHOOL OF SOCIAL WORK The UNIVERSITY of OKLAHOMA</p>	Thursday Opening Reception, Sole Sponsor
 <p>University of Pittsburgh School of Social Work</p>	Coffee Break, Co-Sponsor Doctoral Student Travel Stipend, Co-Sponsor
 <p>W SCHOOL OF SOCIAL WORK UNIVERSITY of WASHINGTON</p>	Coffee Break, Co-Sponsor RCDC Roots and Wings Session II: <i>Federal Funding, Historical Context, and Equity-Focused Research: Navigating Past Foundations and Future Directions</i> , Sole Sponsor
 <p>WashU Brown School</p>	Aaron Rosen Lecture, Sole Sponsor

2026 SSWR SPONSORS

Bronze Level Sponsors – \$3,500

 <p>RUTGERS UNIVERSITY School of Social Work</p>	<p>Community Partner Travel Support, Co-Sponsor RMW III: <i>Spatial Data Science: Visualizing and Analyzing Community Needs</i>, Sole Sponsor</p>
--	---

Friends Level Sponsors – \$2,500

 <p>School of Social Work UNIVERSITY OF CENTRAL FLORIDA</p>	<p>Coffee Break, Co-Sponsor</p>
 <p>Graduate School of Social Work UNIVERSITY OF DENVER</p>	<p>Brief and Brilliant Session, Sole Sponsor</p>
 <p>School of Social Work UNIVERSITY OF ILLINOIS URBANA-CHAMPAIGN</p>	<p>Coffee Break, Co-Sponsor</p>
 <p>Penn Social Policy & Practice UNIVERSITY OF PENNSYLVANIA</p>	<p>Coffee Break, Co-Sponsor</p>

Supporter Level Sponsors – \$2,000

 <p>GADE EST 1977 GROUP FOR THE ADVANCEMENT OF DOCTORAL EDUCATION IN SOCIAL WORK</p>	<p>RCDC Roots and Wings Session I: <i>Funding and Political Realities: Navigating Uncertainty as an Early Career Scholar</i>, Sole Sponsor</p>
 <p>THE UNIVERSITY OF TENNESSEE KNOXVILLE COLLEGE OF SOCIAL WORK</p>	<p>RMW-4: <i>Demystifying Implementation Science: Strategies for Real-World Research and Intervention Impact</i>, Sole Sponsor</p>
 <p>MILWAUKEE UNIVERSITY OF WISCONSIN Helen Bader School of Social Welfare</p>	<p>SSRPCB-2: <i>How Researchers Can Move the Needle for Policy Change</i>, Sole Sponsor</p>

In Memoriam

Dorcas Davis Bowles, PhD
Clark Atlanta University

Jerry Daniel, PhD
Albany State University

Jeffrey Draine, PhD
Temple University

Brian Droubay, PhD
Utah State University

Jeremy Goldbach, PhD
Washington University in St. Louis

James Duncan Lindsey, PhD
University of California, Los Angeles



2026 Distinguished Career Achievement Award



Deborah K. Padgett, PhD
New York University

SSWR and Brown School of Social Work, Washington University in St. Louis 2026 Aaron Rosen Lecture



Karen Fredriksen Goldsen, PhD
University of Washington

2026 Social Policy Researcher Award Senior Scholar Recipient



Cecilia Ayón, PhD, MSW
University of California, Riverside

2026 Social Policy Researcher Award Emerging Scholar Recipient



Annelise Mennicke, PhD
University of North Carolina at Charlotte

2026 SSWR Book Award for Best Scholarly Book Published



Lisa Young Larane, PhD, MSW, LCSW, LMSW
Bryn Mawr College

Larance, Lisa Young (2024). *Broken: Women's Stories of Intimate and Institutional Harm and Repair*. University of California Press.

2026 SSWR Book Award for Best Scholarly Book Published Honorable Mention



Nadine Shaanta Murshid, PhD, MPP
University at Buffalo

Murshid, N. S. (2024). *Intimacies of Violence: Reading Transnational Middle-Class Women in Bangladeshi America*. Oxford University Press.

2026 Deborah K. Padgett Early Career Achievement Award



Janelle Goodwill, PhD
The University of Chicago

2026 Excellence in Research Award



Bernadine Y. Waller, PhD
Columbia University



Victoria A. Joseph, MPH
Columbia University



Katherine M. Keyes, PhD
Columbia University

Waller, B. Y., Joseph, V. A., and Keyes, K. M. (2024). "Racial inequities in homicide rates and homicide methods among Black and White women aged 25–44 years in the USA, 1999–2020: A cross-sectional time-series study." *The Lancet*, 403(10430), 935–945. [https://doi.org/10.1016/S0140-6736\(23\)02279-1](https://doi.org/10.1016/S0140-6736(23)02279-1)

2026 Excellence in Research Award Honorable Mention



Theda Rose, PhD
University of Maryland at Baltimore



Sean Joe, PhD
Washington University in St. Louis

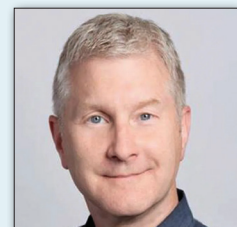

Gregory R. Hancock, PhD
University of Maryland

Rose, T., Joe, S., and Hancock, G. R. (2024). "Mediators that matter: Psychological distress, developmental assets, and educational outcomes among Black youth." *Journal of Educational Psychology*. Advance online publication. <https://doi.org/10.1037/edu0000876>

2026 Excellence in Research Award Honorable Mention



Bongki Woo, PhD
University of South Carolina

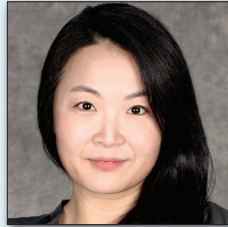

Jungmi Jun, PhD
University of South Carolina



Joon Kyung Kim, PhD
University of Rhode Island

Woo, B., Jun, J., and Kim, J. K. (2024). "Racial discrimination and depressive symptoms among Asian Americans: Moderating effects of colorblind racial attitude and nativity." *Ethnicity and Health*, 30(3), 337–347.
<https://doi.org/10.1080/13557858.2024.2442311>

2026 Community-Research Partnership Award



Ramona Beltrán, PhD
University of Denver



Olga González, MNM
Cultivando

2026 Community-Research Partnership Award Honorable Mention



Jane J. Lee, PhD
University of Southern California



Martha A. Zuniga Ortiz, MCS
Entre Hermanos

Sponsored by  **cognella**[®]

2026 SSWR AWARDS

2026 Outstanding Social Work Doctoral Dissertation Award



Nari Yoo, PhD
New York University

"Unraveling Ethnic Disparities: Immigrants with Language Barriers"



Durrell M. Washington, Sr., PhD
The University of Chicago

"Policy, and Practice: Invisible Wounds and Sibling Dynamics: A Narrative Study Investigating the influence of Juvenile Incarceration on Black Family Life"

2026 Outstanding Social Work Doctoral Dissertation Award Honorable Mention



Monica De La Cruz, PhD
University of California, Berkeley

"Beyond Sticks and Stones: How Poverty Narratives Shape Public Assistance and Support for Guaranteed Income"

2026 Doctoral Fellows Award



Alex Fixler
University of Pittsburgh

"Policies, Penalties, and Public Safety: Measuring the Impact of State Drug Laws on Arrest and Overdose Rates"



Laura Soltani
University of Minnesota - Twin Cities

"Unconditional Cash Transfers in Refugee Resettlement: A Pilot Evaluation"

2026 Society for Social Work and Research (SSWR) Fellows

Congratulations to the 2026 class of SSWR Fellows! SSWR Fellow is an honor to recognize current SSWR members for their individual accomplishments, leadership, and contributions to SSWR as a scientific society. SSWR Fellows serve as role models and mentors for individuals pursuing careers in social work research and help advance the mission of the Society for Social Work and Research "...to advance, disseminate, and translate research that addresses issues of social work practice and policy and promotes a diverse, just, and equitable society."

Samira Ali, PhD
University of Houston

Hsun-Ta Hsu, PhD
University of North Carolina at Chapel Hill

Theresa Anasti, PhD
Washington University in St. Louis

Tina Jiwatram-Negron, PhD
Arizona State University

Annahita Ball, PhD
University at Buffalo, State University of New York

Joyce Lee, PhD
The Ohio State University

Shanondora Billiot, PhD
Arizona State University

Robert Motley, PhD
Boston College

Joan Blakey, PhD
University of Minnesota

Yunju Nam, PhD
University at Buffalo, State University of New York

Lindsay Bornheimer, PhD
University of Michigan

Corey Shdaimah, PhD
University of Maryland, Baltimore

Gina Chowa, PhD
University of North Carolina at Chapel Hill

Matthew Smith, PhD
University of Michigan

Courtney Cronley, PhD
The University of Tennessee

Bryan Victor, PhD
Wayne State University

Odessa Gonzalez Benson, PhD
University of Michigan

Kevin White, PhD
East Carolina University

Baorong Guo, PhD
University of Missouri-St. Louis

Anao Zhang, PhD
University of Michigan

William Hall, PhD
University of North Carolina at Chapel Hill

The 2026 class of SSWR Fellows will be recognized during the Saturday Fellows and Awards Presentation, January 17, 2026, 2:00 pm – 2:30 pm, Eastern. All SSWR Fellows are identified with black and gold stripe name badge ribbons.



Dr. Li-Mei
Chen



Dr. Michelle
Hand



Dr. Denise
Hines



Dr. Emily Ihara



Dr. Megumi
Inoue



Dr. Holly Matto



Dr. Keiana
Mayfield



Dr. Anna Parisi



Dr. Amy Page



Dr. Sunny Shin



Dr. Melissa
Villodas



SCAN ME

Society for Social Work and Research 2025 – 2026 Board of Directors



President

Ramona Denby-Brinson, PhD
University of North Carolina at Chapel Hill



President-Elect

Kirk Foster, PhD
The University of Texas at Arlington



Vice President

Hyeouk "Chris" Hahm, PhD
Boston University



Vice President-Elect

Rocío Calvo, PhD
Boston College



Past Vice President

Mary Ohmer, PhD
University of Pittsburgh



Secretary

David Becerra, PhD
Texas Christian University



Treasurer

Virginia "Ginny" Ramseyer Winter, PhD
University of Minnesota-Twin Cities

**Society for Social Work and Research
2025 – 2026 Board of Directors**

Directors-at-Large



Adrienne Baldwin-White, PhD
Virginia Commonwealth University



Joyce Lee, PhD
The Ohio State University



Joan Blakey, PhD
University of Minnesota-Twin Cities



Shuang Lu, PhD
University of Central Florida



Karen Bullock, PhD, LICSW, FGSA,
APHSW-C
Boston College



Abha Rai, PhD
Loyola University Chicago



Tamara Cadet, PhD
University of Pennsylvania



Samantha Teixeira, PhD
Boston College



Kelli Canada, PhD, LCSW
University of Missouri



Early Career Director-at-Large
Justin Harty, PhD
Arizona State University



Youseung Kim, PhD
Clark Atlanta University

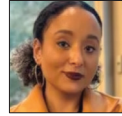

Doctoral Student Director-at-Large
Fatima Mabrouk, MSW
New York University

Society for Social Work and Research 2026 Conference Committee

Vice President and 2026 Conference Chair, Hyeouk “Chris” Hahm, PhD, Boston University
Vice President-elect, Rocio Calvo, PhD, Boston College
Past Vice President, Mary Ohmer, PhD, University of Pittsburgh
President, Ramona Denby-Brinson, PhD, University of North Carolina at Chapel Hill
President-Elect, Kirk Foster, PhD, University of Texas at Arlington
Social Policy Committee Chair, Adrienne Baldwin-White, PhD, Virginia Commonwealth University
Volunteer Coordinator, Abha Rai, PhD, Loyola University Chicago
Awards Committee Chair, Joan Blakey, PhD, University of Minnesota-Twin Cities
RCDC Co-chair, Karen Bullock, PhD, Boston College
RCDC Co-chair, Justin Harty, PhD, Arizona State University
Doctoral Student Director-at-Large and Doctoral Student Committee Chair, Fatima Mabrouk, MSW, New York University

Society for Social Work and Research 2026 Conference Abstract Cluster Co-Chairs

Adolescent and Youth Development (ADOL): Hyunkag Cho, PhD, Michigan State University; Genevieve Graaf, PhD, University of Texas at Arlington; Angela Malorni, PhD, Rutgers University; Yanfeng Xu, PhD, University of South Carolina

Aging Services and Gerontology (A&G): Hyun Kang, PhD, James Madison University; Jooyoung Kong, PhD, University of Wisconsin-Madison; Christina Miyawaki, PhD, University of Houston

American Indian, Alaska Native, Native Hawaiian and Global Indigenous Populations (Indigenous Cluster): Shanondora Billiot, PhD, Arizona State University; Katie Schultz, PhD, University of Michigan

Asian and Asian-Pacific Islander Focused-Research (AAPIFR): Isok Kim, PhD, University at Buffalo; Hee Yun Lee, PhD, The University of Georgia; Saumya Tripathi, PhD, Binghamton University

Black and African Diaspora Focused-Research (BADFR): James Ellis, PhD, University of Michigan; McKenzie Green, PhD, Virginia Commonwealth University; Camille Quinn, PhD, University of Michigan

Child Welfare (CW): Hui Huang, PhD, University of Texas at Arlington; Miriam Landsman, PhD, University of Iowa; Erika Lewis, PhD, University of Maryland; Abigail Williams-Butler, PhD, Rutgers University

Communities & Neighborhoods (C&N): Andrew Foell, PhD, University of Illinois Chicago; Megan Gilster, PhD, University of Iowa; Amy Krings, PhD, The Ohio State University; Samantha Teixeira, PhD, Boston College

Crime and Criminal Justice (C&CJ): Laura Abrams, PhD, University of California, Los Angeles; Aaron Gottlieb, PhD, The University of Chicago; Robert Motley, Jr., PhD, Boston College

Disability (D): Kristina Lopez, PhD, Arizona State University; Stephen McGarity, PhD, University of Tennessee Knoxville; Laura Wernick, PhD, Fordham University

Gender (G): Venera Bekteshi, PhD, The University of Oklahoma; Shanna Kattari, PhD, University of Michigan; Ankur Srivastava, PhD, The University of North Carolina at Chapel Hill

Leading for Transformative Change: *Aligning Social Work Science with Policy and Practice*

Gender-Based Violence (GBV) (formerly VAWC): Meredith Bagwell-Gray, PhD, The University of Kansas; Sarah Bledsoe, PhD, The University of North Carolina at Chapel Hill; LB Klein, PhD, University of Wisconsin-Madison; Abha Rai, PhD, Loyola University Chicago

Health (H): Chiara Acquati, PhD, University of Houston; Julie Berrett-Abebe, PhD, Fairfield University; Yeonwoo Kim, PhD, University of Texas at Arlington

History (HST): Jane McPherson, PhD, University of Georgia; Jessica Toft, PhD, University of Minnesota

Inequality, Poverty, and Social Welfare Policy (IP&SP): Yoonsook Ha, PhD, Boston University; Kathryn Maguire-Jack, PhD, University of Michigan; Branden McLeod, PhD, University of Illinois Chicago

International Social Work & Global Issues (ISW&GI): Nataliia Gusak, PhD, University of Alaska; Ifrah Magan, PhD, New York University; Proscovia Nabunya, PhD, Washington University in St. Louis

Immigrants and Refugees (I&R): Mary Held, PhD, University of Tennessee Knoxville; Wooksoo Kim, PhD, University at Buffalo; Mitra Naseh, PhD, Washington University in St. Louis

LatinX Focused-Research (LFR): Manuel Cano, PhD, Arizona State University; María Piñeros Leano, PhD, Boston College; Carolina Vélez Grau, PhD, Boston College

Mental Health (MH): Amy Blank Wilson, PhD, The University of North Carolina at Chapel Hill; Lindsay Bornheimer, PhD, University of Michigan; Quenette Walton, PhD, University of Houston

Military Service Members, Veterans and Their Families (MSMVF): Eric Hardiman, PhD, University at Albany; Donna Schuman, PhD, University of Texas at Arlington; Nikki Wooten, PhD, University of South Carolina

Organizations & Management (O&M): Theresa Anasti, PhD, Washington University in St. Louis; Matthew Bakko, PhD, Wayne State University; James Mendiberg, PhD, Hunter College

Race and Ethnicity (R&E): Ryon Cobb, PhD, Rutgers University; Odessa Gonzalez Benson, PhD, University of Michigan; Lailea Noel, PhD, The University of Texas at Austin

Research Design and Measurement (RD&M): Antoinette Farmer, PhD, Rutgers University; Tanya Renn, PhD, Florida State University; Mansoo Yu, PhD, University of Missouri

Research on Social Work Education (RSWE): Joan Blakey, PhD, University of Minnesota; Mingun Lee, PhD, Ohio University; Rolanda Ward, PhD, Niagara University

School Social Work (SSW): Samantha Bates, PhD, The Ohio State University; Danielle Harrell, PhD, University of Texas at Arlington; Andrea Joseph-McCatty, PhD, University of Tennessee Knoxville

Sexual Orientation and Gender Identity (SO&GI): Daniel Jacobson Lopez, PhD, Boston University; Jama Shelton, PhD, Hunter College; Keith Watts, PhD, University of Kentucky

Social Work Practice (SWP): Jessica Bagneris, PhD, University of Houston; Otima Doyle, PhD, University of Illinois Chicago; Ray Eads, PhD, University of Illinois Chicago

Substance Misuse and Addictive Behaviors (SM&AB): Dale Dagar Maglalang, PhD, New York University; Orion Mowbray, PhD, University of Georgia; Jennifer Putney, PhD, University of Vermont

Sustainable Development, Environmental and Climate Justice (SDE&CJ): Greer Hamilton, PhD, University of Michigan; Tonya Hansel, PhD, University of Texas at Arlington; Smitha Rao, PhD, The Ohio State University

Work and Work-Life Policies and Programs (WWLP&P): Kess Ballentine, PhD, Wayne State University; Sehun Oh, PhD, The Ohio State University; Alejandra Ros Pilarz, PhD, University of Wisconsin-Madison



Together, we are building **THE** research powerhouse

We integrate evidence-based research into BSSW, MSW, and PhD programs, engaging students and communities to solve complex social challenges. Our interdisciplinary research centers include:

- Age-Friendly Innovation Center (AFIC)
- LiFEsports
- The Higher Education Center for Alcohol and Drug Misuse Prevention and Recovery (HECAOD)
- Community and Youth Collaborative Institute (CAYCI)
- Center for Intergenerational Research and Practice (CIRP)
- Center for Psychedelic Drug Research & Education (CPDRE)



**Learn more about our
Research and Centers**
csw.osu.edu/CSW-research



THE OHIO STATE UNIVERSITY
COLLEGE OF SOCIAL WORK

**Journal of the Society for Social Work and Research (JSSWR)
Editor-in-Chief, Associate Editors, Managing Editor, and Editorial Assistant**

Editor-in-Chief

Todd I. Herrenkohl, PhD
University of Michigan

Lisa Fedina, PhD
University of Michigan

Bryan Victor, PhD
Wayne State University

Managing Editor

Chelsey Baker-Hauck

Sadaaki Fukui, PhD
Indiana University

Susan Stone, PhD
University of California, Berkeley

Editorial Assistant

Meggie Royer
University of Michigan

Aaron Gottlieb, PhD
University of Illinois Chicago

Anne Williford, PhD
Colorado State University

Associate Editors

Inna Altschul, PhD
University of Denver

Charles Lea, PhD
Columbia University

Yanfeng Xu, PhD
University of South Carolina

David Ansong, PhD
University of North Carolina at
Chapel Hill

Jungeun Olivia Lee, PhD
University of Southern California

Mansoo Yu, PhD
University of Missouri

Anamika Barman Adhikari, PhD
University of Denver

Brandy Maynard, PhD
St. Louis University

Anao Zhang, PhD
University of Michigan

Jennifer L. Bellamy, PhD
Washington University in St. Louis

Boyoung Nam, PhD
Yonsei University

Julie Birkenmaier, PhD
Saint Louis University

Jennifer Dickman Portz, PhD
University of Colorado Anschutz

Qiana L. Brown, PhD
Rutgers, The State University of
New Jersey

Shannon Sliva, PhD
University of Denver

Phyllis Solomon, PhD
University of Pennsylvania

Mary Collins, PhD
Boston University

Valandra, PhD
University of Arkansas

G. Lawrence Farmer, PhD
Fordham University

Thrive Through Evidence. Thrive Through Action.



UTA  School of Social Work
THE UNIVERSITY OF TEXAS AT ARLINGTON

Marriott Marquis Washington, DC
Lobby Level

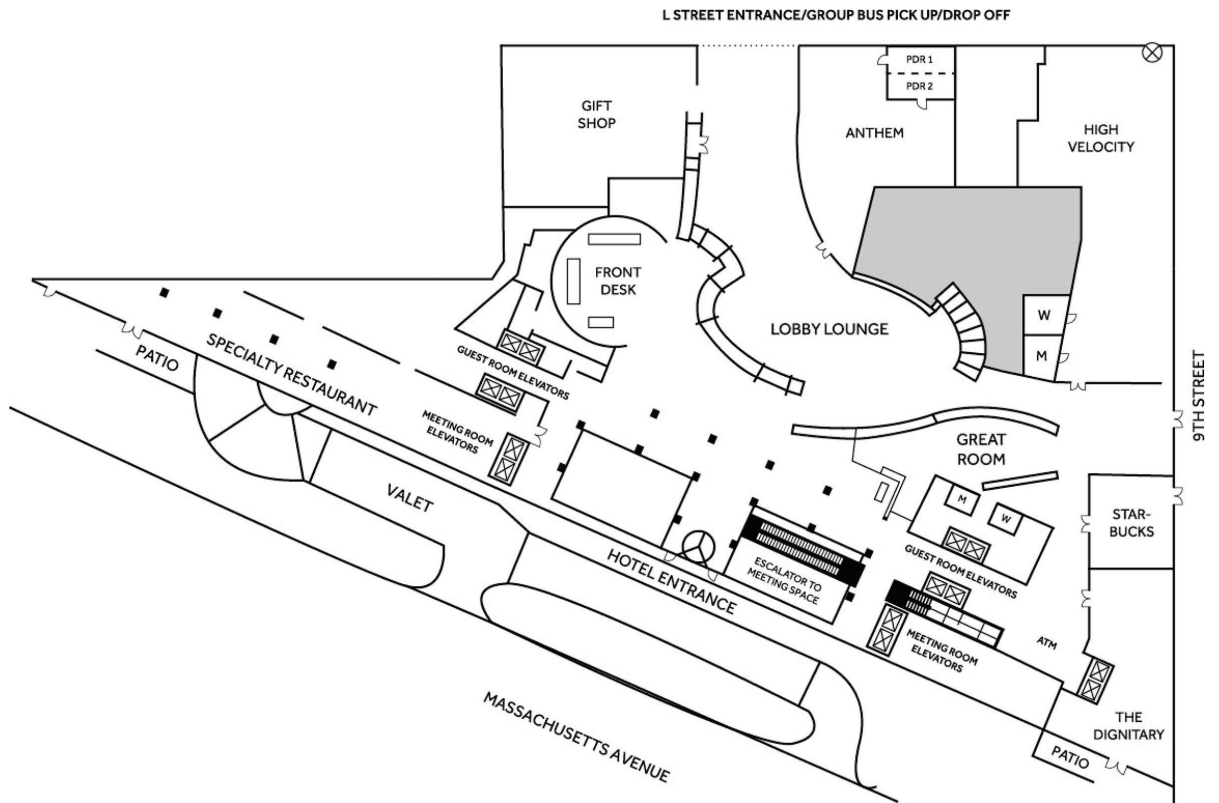

Marriott Marquis Washington, DC

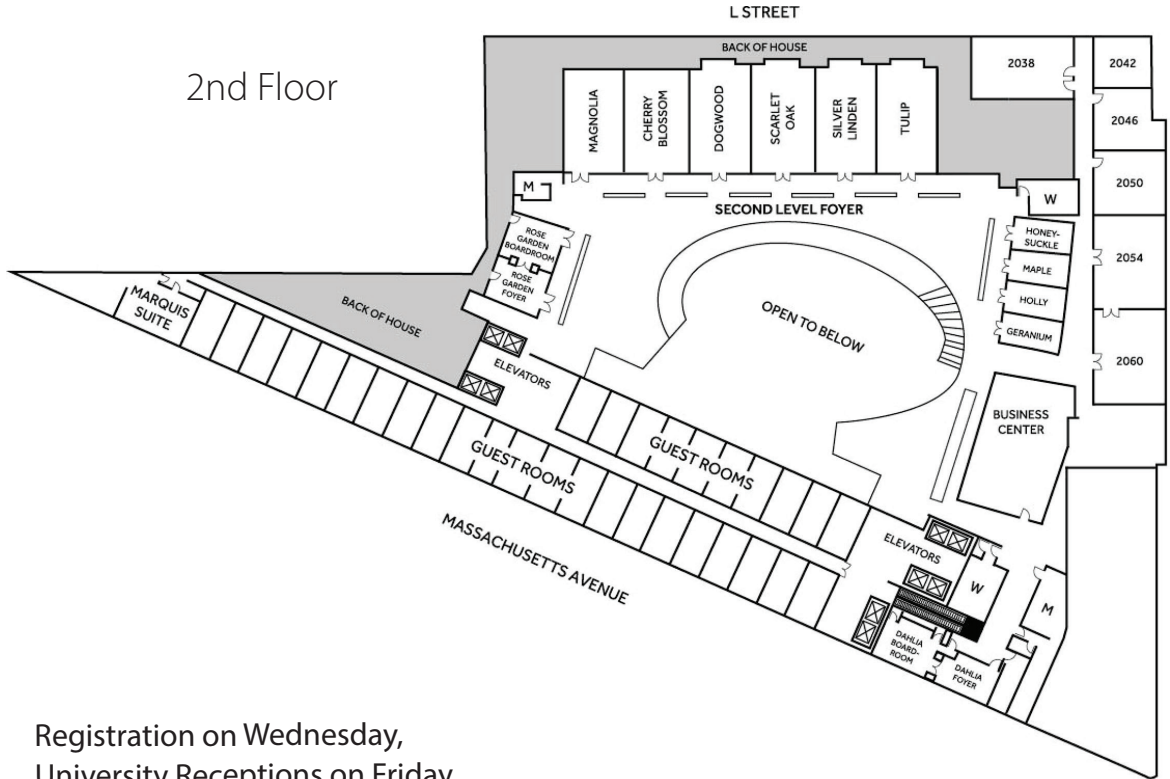

Registration on Wednesday,
University Receptions on Friday

Marriott Marquis Washington, DC
Meeting Level 1

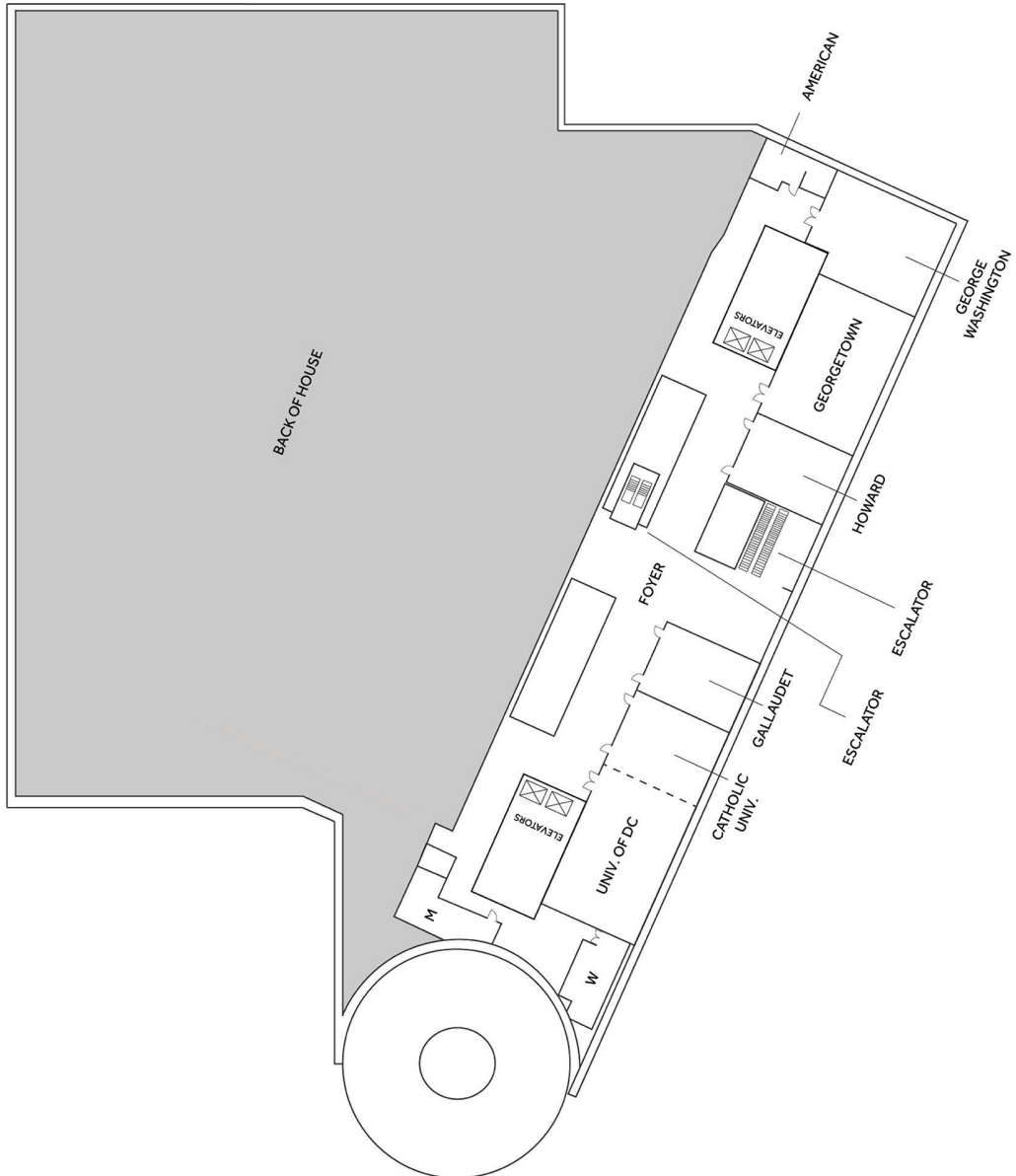

University Receptions on Friday

Marriott Marquis Washington, DC
Meeting Level 2

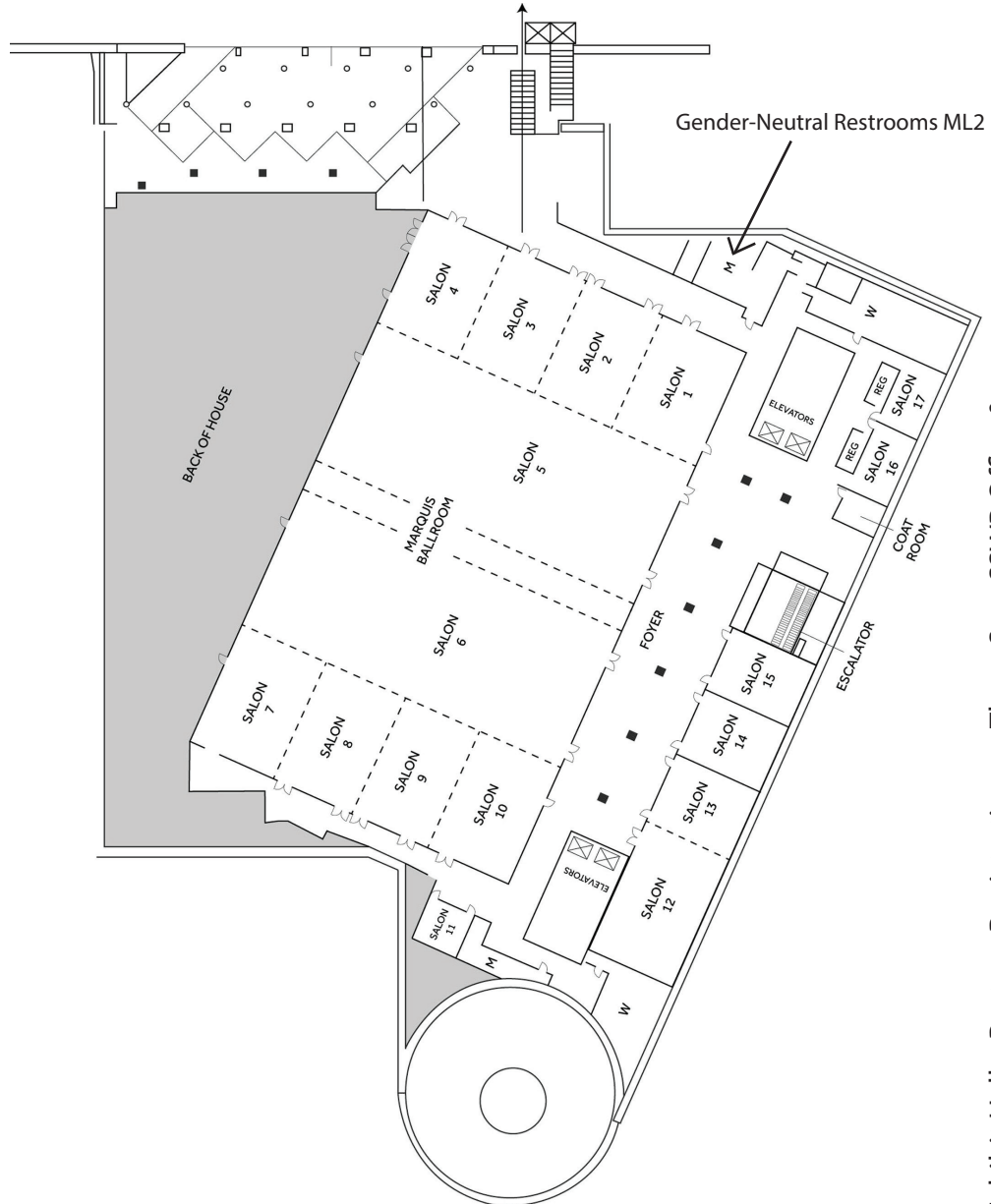
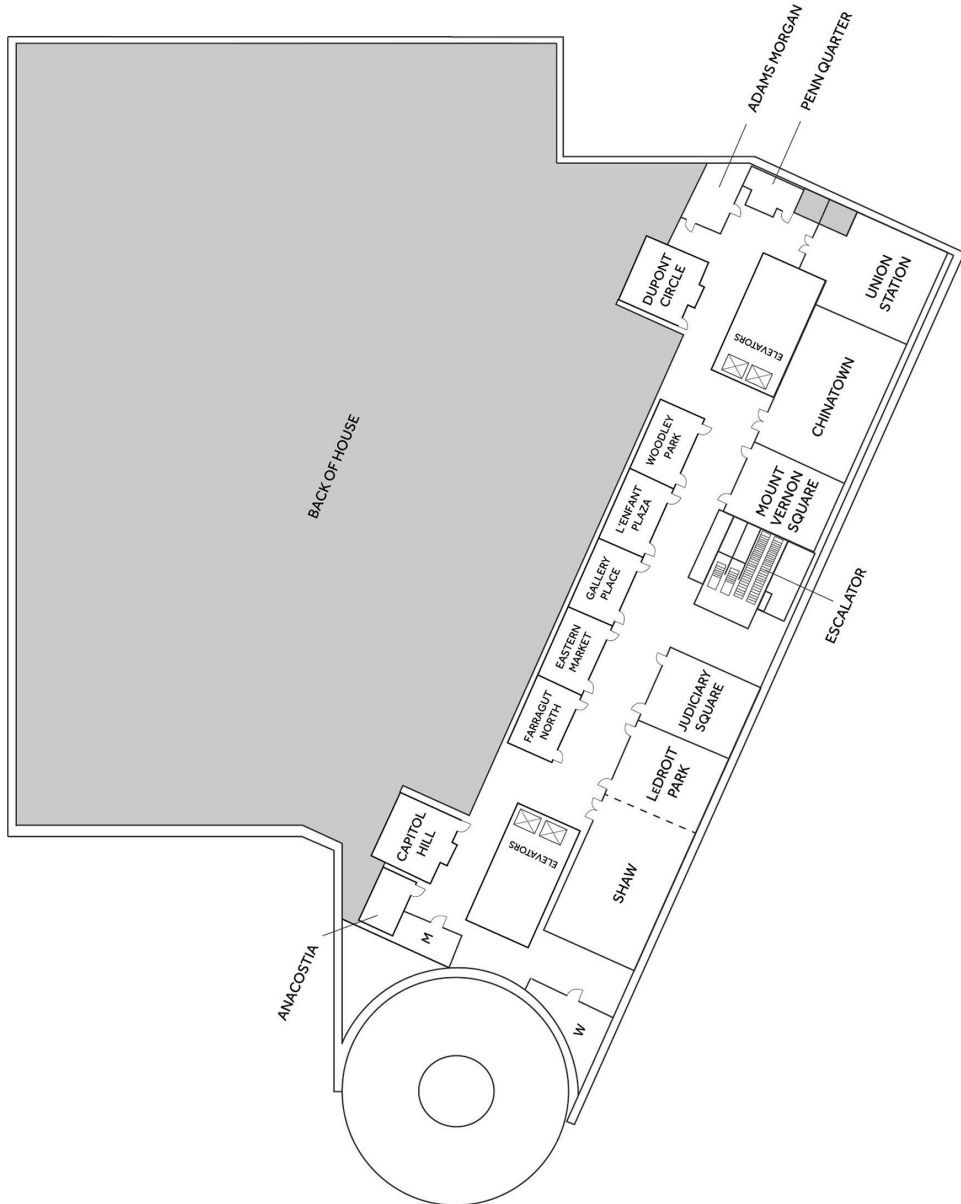

Exhibit Hall, ePosters, Registration on Thurs-Sun, SSWR Office & Membership Office, Concurrent Sessions, Gender-Neutral Restrooms

Marriott Marquis Washington, DC
Meeting Level 3



Affiliate Meetings & Receptions

Marriott Marquis Washington, DC
Meeting Level 4

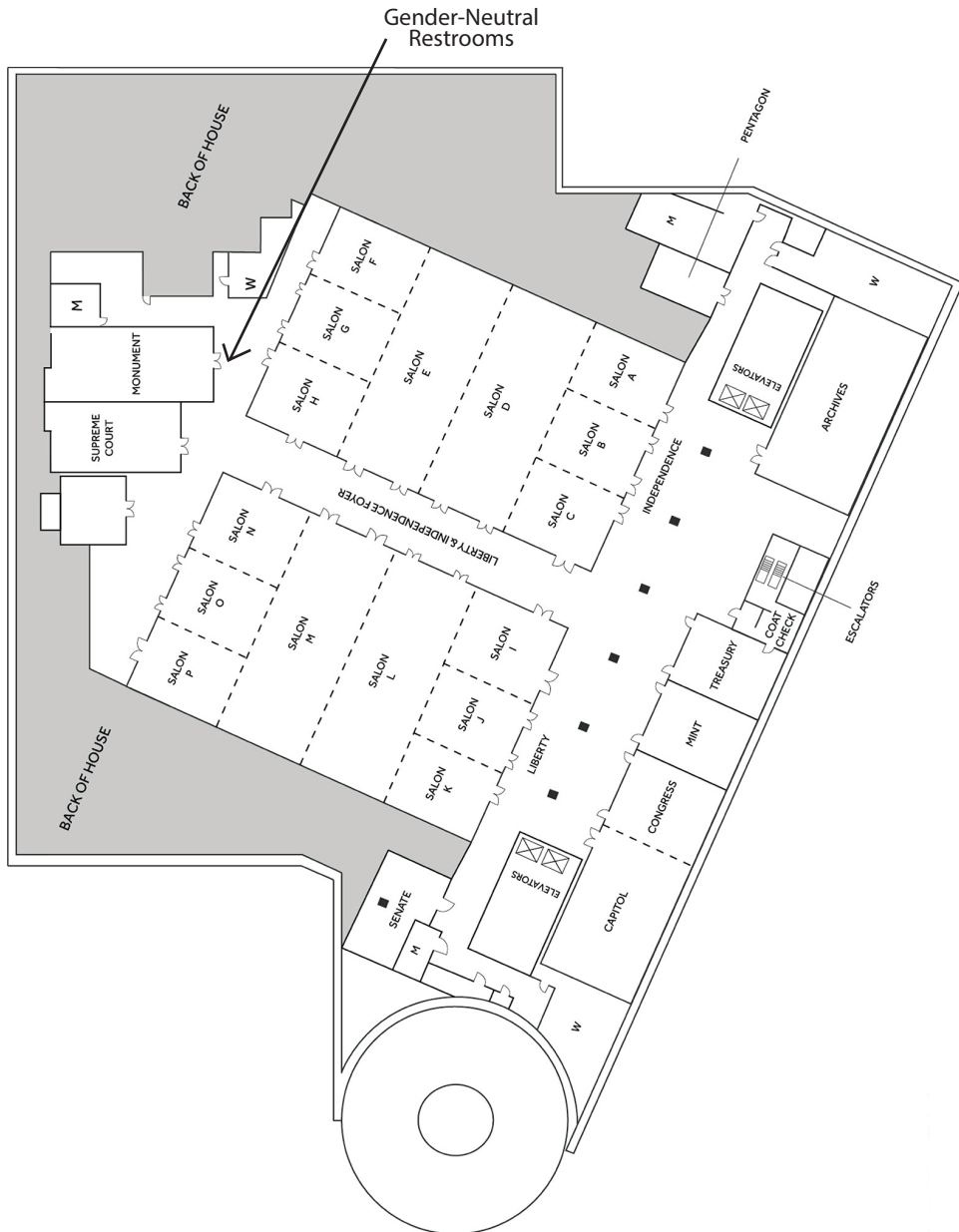

General Sessions, Concurrent Sessions, University Receptions on Friday, Gender-Neutral Restrooms

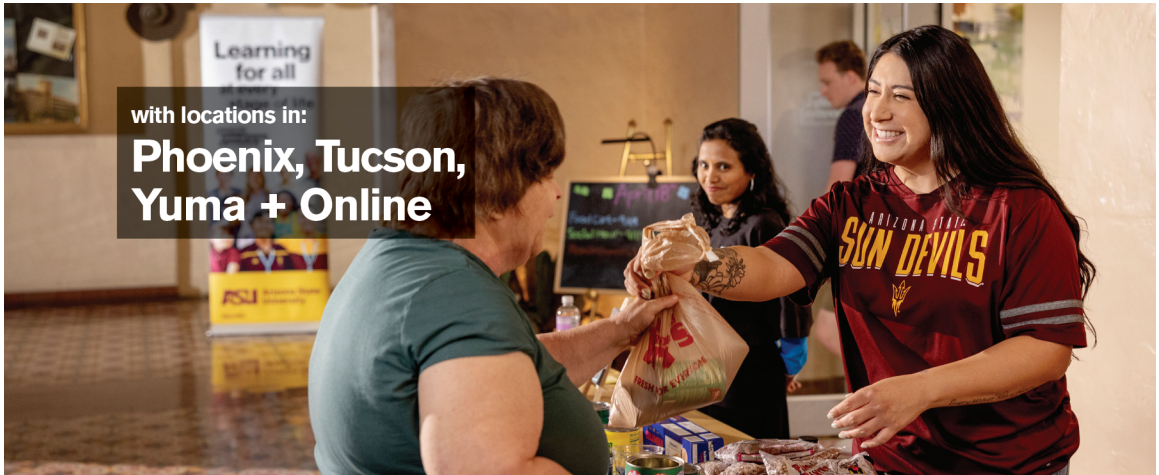

with locations in:

**Phoenix, Tucson,
Yuma + Online**

The School of Social Work at Arizona State University is one of the **largest and most diverse schools of social work in the U.S.**

Within an innovative public research university, we prepare social work practitioners, researchers and advocates to lead positive change in the Southwest, nationally and globally.

Pursue your passion here.

#1
university in
innovation and
global impact

— U.S. News & World Report
and Times Higher Education

**Highly
Productive
Faculty**

#10
social work school
in the U.S. for
faculty productivity

— National Science Foundation

ASU School of
Social Work
Arizona State University



socialwork.asu.edu

An academic unit of the Watts College of
Public Service and Community Solutions

SAVE THE DATES



31st Annual Conference

**Social Work Research at
the Service of Democracy:
Advancing Rigorous Inquiry
for the Common Good**

January 20-24, 2027

Hilton San Francisco Union Square
San Francisco, CA

Call for Papers will be available March 2026.

Abstract Submission Deadline: April 15, 2026